

**TEENAGE MUTANT NINJA
TURTLES**
**MINI
MUTANTS
TURTLE-TOP
PLAYSETS™**

Kids,
follow these
simple blueprints,
it's easy!



When the Turtles get tough, the Foot Fools gets rough! Keep track of the score with the "Sock it to 'em" Score Counters that tell who's hot and who's not. Just rotate the score counters as shown to keep track of what's happening.

Turtles love to watch TV! Insert and swing out the Maximum Coverage View Screen so our fearless Forward Leonardo, Center Michaelangelo and Guard Raphael can watch their awesome talent on the instant replay!

Insert the Sewerpipe Return Swing blocker into the pipe socket as shown.

For some dynamic D, attach Guard Raphael to the end of the string and you can block any shot. But Dudes, watch out for that goaltending call!

Tilt playset on its side and open the bottom door. The basketballs will automatically roll out the opening.

Now for some real action. Line up the Rimshot Freethrower with Shootin' Action where a three-pointer's really gonna hurt. Place the basketball in the thrower and carefully push down on the lever with your finger and release to shoot the basketball into the Trashed Garbage Can Hoop as shown. You shoot, you score, you win!

Try out the Tongue Flipper Turtle Launcher for some extra Defense when those Foot Fools try to score big time! Place Center Michaelangelo onto the manhole. With just a flick it's over quick as even the highest arcin' tosses come down without a point. All you have to do is press down on the Turtle Tongue and watch a Turtle fly.

Ready for some B Ball? Swing out the Trashed Garbage Can Hoop as shown so our Turtle Team can test its talent.

Place the Slam Dunk Arm onto the support as shown. Get ready for some in your Turtle face dunking.

STAND HERE:

TO OPEN the Playset: Firmly hold the bottom half of DONATELLO'S head with the one hand. Pull up on the upper half and raise it to a vertical position.

Fold down DONATELLO'S mask as shown to help support the upper half as you play in and around the Mini-Mutant DONATELLO Basketball Playset.

Mount the Slammin' Sewerpipe Return beneath the Trashed Garbage Can Hoop on the pin as shown. Basketballs go in the hole and out the bottom.

Place labels 1-7 as shown.

TO CLOSE the Playset: First, place all accessories and parts back into the head, then carefully lower the upper shell. Watch your fingers, dudes!

Hey Dudes and Dudettes, if you want to, try to see how many different ways you can put all the stuff back and see how fast you can do it.

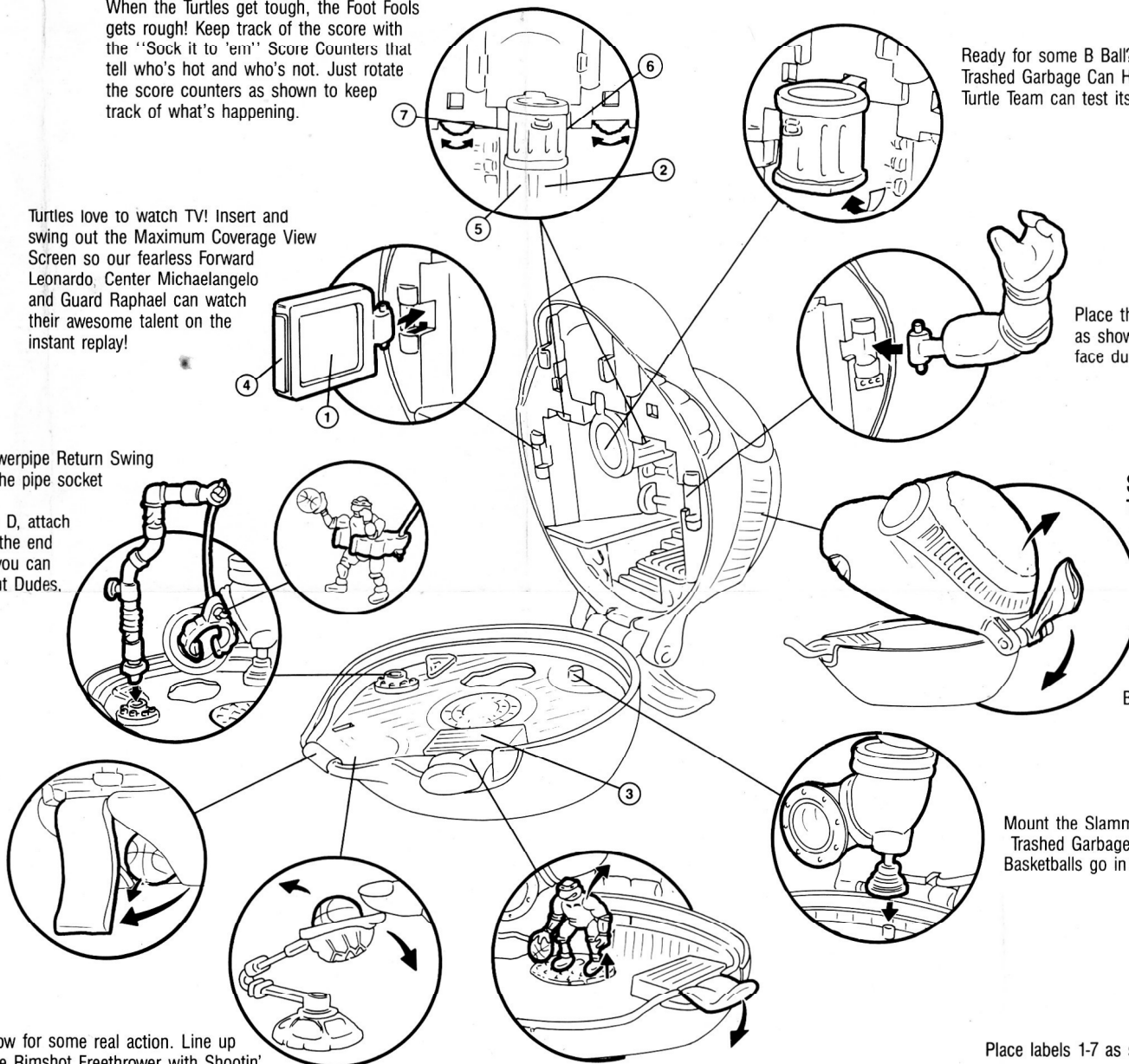

Playmates

ASST. NO. 3460
STOCK NO. 3462
AGES 4 AND UP