

# TEENAGE MUTANT NINJA TURTLES

Kids,  
follow these  
simple blueprints,  
it's easy!

## Assembly

- Start in the news scooping cycle position with super cycle seat and sewer-scanning gullwings fully extended as shown.
- Plug the wacky Ninja windshield and remote Turtle Communicator into the front section of the cycle as indicated.
- Snap the Turtle cam to the top of the pop-up Turtle cam console, and plug the 2-microphone missiles to each side of the super cycle seat spoiler as shown.
- Snap the news cam to the left sewer scanning gullwing and the satellite dish to the right sewer scanning gullwing as indicated. (Pieces are interchangeable).
- Plug the Ninja star hubs to the cycle wheels.
- Place labels 1-30 as shown.

## Directions

- To Transform the News-scooping cycle into the high speeding Mutant street bike, lift the super cycle seat, fold down the pop-up turtle cam console and lower the supercycle seat. Remove the news cam and satellite dish from the sewer scanning gullwings, and fold up gullwings into cycle.
- Place your favorite Turtle teen and April O'Neil on the super cycle seat and cruise the city streets.
- To broadcast live, transform the mutant street bike back to the news-scoopin' newsycle (just reverse the instructions in the first paragraph of this section). Now the Turtle news hounds and April O'Neil can cover any story at top speed.

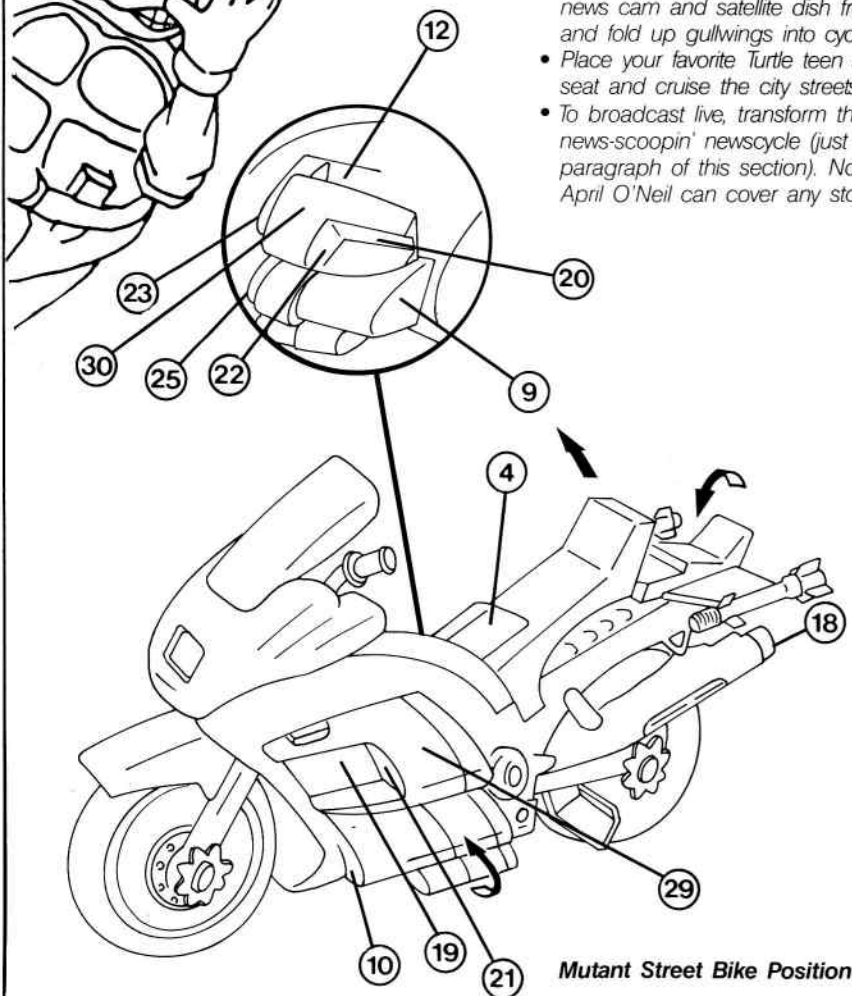

Mutant Street Bike Position

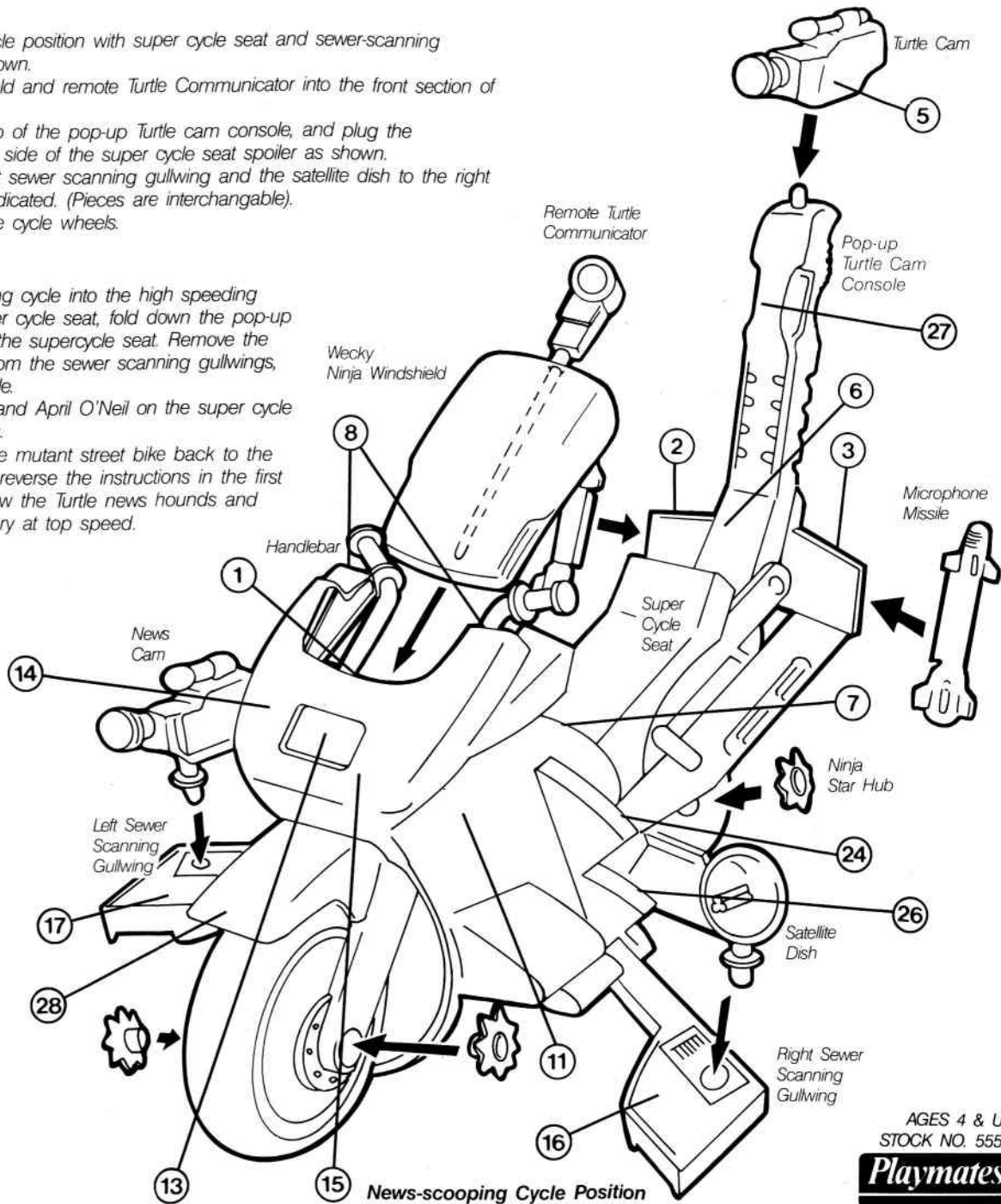

News-scooping Cycle Position

AGES 4 & UP  
STOCK NO. 5557

Playmates™